

Fastening- and protection material

HOSE CLAMP TWO SIDED (DIN72573)

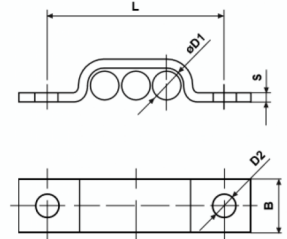
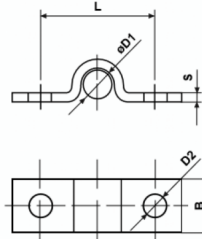

Partnr	Nr / Hose mm	d1	d2	L	B	S	Material
1114-0000-0401	1 x 4 mm	4	4.8	17	10	1	Galvanised
1114-0000-0402	2 x 4 mm	4	4.8	21	10	1	Galvanised
1114-0000-0404	4 x 4 mm	4	4.8	32	10	1	Galvanised
1114-0000-0406	6 x 4 mm	4	4.8	40	10	1	Galvanised
1114-0000-0601	1 x 6 mm	6	4.8	20	10	1	Galvanised
1114-0000-0602	2 x 6 mm	6	4.8	26	10	1	Galvanised
1114-0000-0603	3 x 6 mm	6	4.8	33	10	1	Galvanised
1114-0000-0604	4 x 6 mm	6	4.8	39	10	1	Galvanised
1114-0000-0605	5 x 6 mm	6	4.8	45	10	1	Galvanised
1114-0000-0606	6 x 6 mm	6	4.8	52	10	1	Galvanised
1114-0000-0801	1 x 8 mm	8	4.8	22	10	1	Galvanised
1114-0000-0802	2 x 8 mm	8	4.8	30	10	1	Galvanised
1114-0000-0803	3 x 8 mm	8	4.8	39	10	1	Galvanised
1114-0000-0804	4 x 8 mm	8	4.8	47	10	1	Galvanised
1114-0000-0805	5 x 8 mm	8	4.8	56	10	1	Galvanised
1114-2000-0601	1 x 6 mm	6	4.8	20	10	1	Stainless steel 316TI
1114-2000-0602	2 x 6 mm	6	4.8	26	10	1	Stainless steel 316TI
1114-2000-0603	3 x 6 mm	6	4.8	33	10	1	Stainless steel 316TI
1114-2000-0604	4 x 6 mm	6	4.8	39	10	1	Stainless steel 316TI
1114-2000-0605	5 x 6 mm	6	4.8	45	10	1	Stainless steel 316TI
1114-2000-0606	6 x 6 mm	6	4.8	52	10	1	Stainless steel 316TI
1114-2000-0801	1 x 8 mm	8	4.8	22	10	1	Stainless steel 316TI

Partnr	Nr / Hose mm	d1	d2	L	B	S	Material
1114-2000-0802	2 x 8 mm	8	4.8	30	10	1	Stainless steel 316TI
1114-2000-0803	3 x 8 mm	8	4.8	39	10	1	Stainless steel 316TI
1114-2000-0804	4 x 8 mm	8	4.8	47	10	1	Stainless steel 316TI

Two-sided pipe clamp, for attaching one to six hoses.