

Cutting ring fittings

STRAIGHT SCREW FITTING (GE)

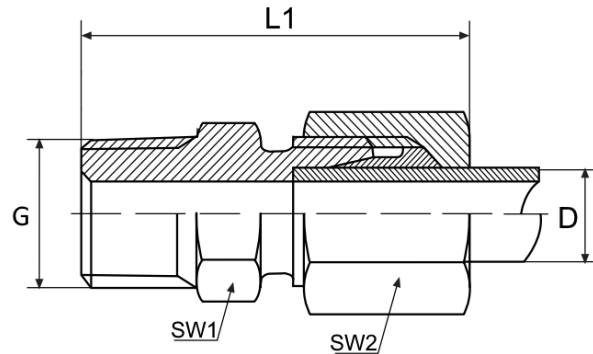

| Partnr | Omschrijving | D | Serie | G | SW1 | SW2 | L1 | Material |
|----------------|-------------------|---|-------|--------------|-----|-----|------|-------------|
| 0413-0004-0406 | GE04 LL M6x0,75 | 4 | LL | M6x0.75 con | 9 | 10 | 26 | Zinc-nickel |
| 0413-0003-0406 | GE04 LL M6x1 | 4 | LL | M6x1 con | 9 | 10 | 26 | Zinc-nickel |
| 0413-0007-0406 | GE04 LL M6x1 KORT | 4 | LL | M6x1 con | 9 | 10 | 24 | Zinc-nickel |
| 0413-0003-0408 | GE04 LL M8x1 | 4 | LL | M8x1 con | 10 | 10 | 26 | Zinc-nickel |
| 0413-0004-0408 | GE04 LL M8x1,25 | 4 | LL | M8x1,25 con | 10 | 10 | 26 | Zinc-nickel |
| 0413-0003-0410 | GE04 LL M10x1 | 4 | LL | M10x1 con | 11 | 10 | 26 | Zinc-nickel |
| 0413-0003-0508 | GE05 LL M8x1 | 5 | LL | M8x1 con | 10 | 10 | 26 | Zinc-nickel |
| 0413-0003-0606 | GE06 LL M6x1 | 6 | LL | M6x1 con | 11 | 12 | 26 | Zinc-nickel |
| 0413-0003-0608 | GE06 LL M8x1 | 6 | LL | M8x1 con | 11 | 12 | 26 | Zinc-nickel |
| 0413-0004-0608 | GE06 LL M8x1,25 | 6 | LL | M8x1,25 con | 11 | 12 | 26 | Zinc-nickel |
| 0413-0003-0610 | GE06 LL M10x1 | 6 | LL | M10x1 con | 11 | 12 | 26 | Zinc-nickel |
| 0413-0103-0402 | GE04 LL R1/8 | 4 | LL | R1/8 BSP con | 11 | 10 | 26 | Zinc-nickel |
| 0413-0107-0402 | GE04 LL R1/8 CYL | 4 | LL | R1/8 BSP cyl | 14 | 10 | 28 | Zinc-nickel |
| 0413-0103-0502 | GE05 LL R1/8 | 5 | LL | R1/8 BSP con | 11 | 10 | 26 | Zinc-nickel |
| 0413-0103-0602 | GE06 LL R1/8 | 6 | LL | R1/8 BSP con | 11 | 12 | 26 | Zinc-nickel |
| 0413-0104-0602 | GE06 LL R1/8 CYL | 6 | LL | R1/8 BSP cyl | 14 | 12 | 27,5 | Zinc-nickel |
| 0413-0103-0802 | GE08 LL R1/8 | 8 | LL | R1/8 BSP con | 11 | 14 | 28 | Zinc-nickel |
| 0413-0103-0804 | GE08 LL R1/4 | 8 | LL | R1/4 BSP con | 14 | 14 | 32,5 | Galvanised |
| 0413-0003-0810 | GE08 LL M10x1 | 8 | LL | M10x1 con | 12 | 14 | 28 | Zinc-nickel |
| 0413-0123-0604 | GE06 LR 1/4 | 6 | L | R1/4 BSP cyl | 19 | 14 | 39 | Zinc-nickel |
| 0413-0023-0610 | GE06 L M10x1 | 6 | L | M10x1 cyl | 14 | 14 | 34 | Zinc-nickel |
| 0413-0023-0614 | GE06 L M14x1 | 6 | L | M14x1 cyl | 19 | 14 | 39 | Zinc-nickel |

| Partnr | Omschrijving | D | Serie | G | SW1 | SW2 | L1 | Material |
|----------------|-------------------|----|-------|--------------|-----|-----|------|-----------------------|
| 0413-0123-0602 | GE06 LR 1/8 | 6 | L | R1/8 BSP cyl | 14 | 14 | 34 | Zinc-nickel |
| 0413-0123-0606 | GE06 LR 3/8 | 6 | L | R3/8 BSP cyl | 22 | 14 | 40 | Zinc-nickel |
| 0413-0123-0802 | GE08 LR 1/8 | 8 | L | R1/8 BSP cyl | 14 | 17 | 35 | Zinc-nickel |
| 0413-0123-0804 | GE08 LR 1/4 | 8 | L | R1/4 BSP cyl | 19 | 17 | 40 | Zinc-nickel |
| 0413-0023-0810 | GE08 L M10x1 | 8 | L | M10x1 cyl | 14 | 16 | 35 | Zinc-nickel |
| 0413-0023-1010 | GE10 L M10x1 | 10 | L | M10x1 cyl | 17 | 19 | 35 | Zinc-nickel |
| 0413-0123-1004 | GE10 LR 1/4 | 10 | L | R1/4 BSP cyl | 19 | 19 | 40 | Zinc-nickel |
| 0413-0123-1002 | GE10 LR 1/8 | 10 | L | R1/8 BSP cyl | 17 | 19 | 36,5 | Zinc-nickel |
| 0413-2003-0406 | GE04 LL M6x1 | 4 | LL | M6x1 con | 9 | 10 | 26 | Stainless steel 316Ti |
| 0413-2003-0408 | GE04 LL M8x1 | 4 | LL | M8x1 con | 10 | 10 | 26 | Stainless steel 316Ti |
| 0413-2003-0410 | GE04 LL M10x1 | 4 | LL | M10x1 con | 10 | 12 | 26 | Stainless steel 316Ti |
| 0413-2004-0410 | GE04 LL M10x1 CYL | 4 | LL | M10x1 cyl | 14 | 10 | 28 | Stainless steel 316Ti |
| 0413-2103-0402 | GE04 LL R1/8 | 4 | LL | R1/8 BSP con | 11 | 10 | 28 | Stainless steel 316Ti |
| 0413-2104-0402 | GE04 LL R1/8 CYL | 4 | LL | R1/8 BSP cyl | 11 | 10 | 28 | Stainless steel 316Ti |
| 0413-2003-0606 | GE06 LL M6x1 | 6 | LL | M6x1 con | 11 | 12 | 26 | Stainless steel 316Ti |
| 0413-2003-0608 | GE06 LL M8x1 | 6 | LL | M8x1 con | 11 | 12 | 28 | Stainless steel 316Ti |
| 0413-2004-0608 | GE06 LL M8x1,25 | 6 | LL | M8x1,25 con | 11 | 12 | 28 | Stainless steel 316Ti |
| 0413-2003-0610 | GE08 LL M10x1 | 6 | LL | M10x1 con | 11 | 12 | 26 | Stainless steel 316Ti |
| 0413-2004-0610 | GE06 LL M10x1 CYL | 6 | LL | M10x1 cyl | 14 | 12 | 30 | Stainless steel 316Ti |
| 0413-2103-0602 | GE06 LL R1/8 | 6 | LL | R1/8 BSP con | 11 | 12 | 28 | Stainless steel 316Ti |
| 0413-2104-0602 | GE06 LL R1/8 CYL | 6 | LL | R1/8 BSP cyl | 14 | 12 | 29,5 | Stainless steel 316Ti |
| 0413-2023-0610 | GE06 L M10x1 | 6 | L | M10x1 cyl | 14 | 14 | 34 | Stainless steel 316Ti |
| 0413-2003-0806 | GE08 LL M6x1 | 8 | LL | M6x1 con | 12 | 14 | 30 | Stainless steel 316Ti |
| 0413-2003-0808 | GE08 LL M8x1 | 8 | LL | M8x1 con | 12 | 14 | 30 | Stainless steel 316Ti |
| 0413-2003-0810 | GE08 LL M10x1 | 8 | LL | M10x1 con | 12 | 14 | 30 | Stainless steel 316Ti |
| 0413-2103-0802 | GE08 LL R1/8 | 8 | LL | R1/8 BSP con | 12 | 14 | 30 | Stainless steel 316Ti |
| 0413-2104-0802 | GE08 LL R1/8 CYL | 8 | LL | R1/8 BSP cyl | 12 | 14 | 30 | Stainless steel 316Ti |
| 0413-2023-0810 | GE08 L M10x1 | 8 | L | M10x1 cyl | 14 | 16 | 35 | Stainless steel 316Ti |

For connecting and attaching central lubrication pipes and hoses to metric and metric / BSP connections of your central lubrication system. These quick couplings are fully standardized according to DIN 2353 and are available in BEKA, LINCOLN and SKF variants.

See the table below for all available variants.
Material: Zinc-Nickel, stainless steel 316Ti