

Cutting ring fittings

ELBOW SCREW FITTING (WE)

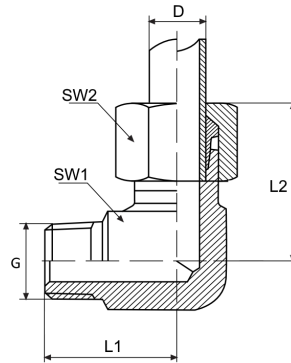

Partnr	Omschrijving	D	Serie	G	SW1	SW2	L1	L2	Material
0419-0003-0406	WE04 LL M6x1	4	LL	M6x1 con	9	10	17	21	Zinc-nickel
0419-0003-0408	WE04 LL M8x1	4	LL	M8x1 con	9	10	17	21	Zinc-nickel
0419-0003-0410	WE04 LL M10x1	4	LL	M10x1 con	11	10	17	21	Zinc-nickel
0419-0103-0402	WE04 LL R1/8	4	LL	R1/8 BSP con	9	10	17	21	Zinc-nickel
0419-0003-0606	WE06 LL M6x1	6	LL	M6x1 con	11	12	17	22	Zinc-nickel
0419-0003-0608	WE06 LL M8x1	6	LL	M8x1 con	11	12	17	22	Zinc-nickel
0419-0003-0610	WE06 LL M10x1	6	LL	M10x1 con	11	12	17	22	Zinc-nickel
0419-0103-0602	WE06 LL R1/8	6	LL	R1/8 BSP con	11	12	17	22	Zinc-nickel
0419-0004-0408	WE04 LL M8x1,25	4	LL	M8x1,25 con	9	10	17	21	Zinc-nickel
0419-0004-0608	WE06 LL M8x1,25	6	LL	M8x1,25 con	11	12	17	22	Zinc-nickel
0419-0003-0810	WE08 LL M10x1	8	LL	M10x1 con	12	14	17	25	Zinc-nickel
0419-0103-0802	WE08 LL R1/8	8	LL	R1/8 BSP con	11	12	17	22	Zinc-nickel
0419-0123-0602	WE06 L R1/8	6	LL	R1/8 BSP con	12	14	21	29	Zinc-nickel
0419-0123-0604	WE06 L R1/4	6	LL	R1/4 BSP con	14	14	26	28,5	Zinc-nickel
0419-2003-0406	WE04 LL M6x1	4	LL	M6x1 con	9	10	17	21	Stainless steel 316TI
0419-2003-0408	WE04 LL M8x1	4	LL	M8x1 con	9	10	17	21	Stainless steel 316TI
0419-2003-0410	WE04 LL M10x1	4	LL	M10x1 con	9	10	17	22	Stainless steel 316TI
0419-2103-0402	WE04 LL R1/8	4	LL	R1/8 BSP con	9	10	17	21	Stainless steel 316TI
0419-2003-0606	WE06 LL M6x1	6	LL	M6x1 con	11	12	17	22	Stainless steel 316TI
0419-2003-0608	WE06 LL M8x1	6	LL	M8x1 con	11	12	17	22	Stainless steel 316TI
0419-2003-0610	WE06 LL M10x1	6	LL	M10x1 con	11	12	17	22	Stainless steel 316TI
0419-2103-0602	WE06 LL R1/8	6	LL	R1/8 BSP con	9	12	17	22	Stainless steel 316TI

Partnr	Omschrijving	D	Serie	G	SW1	SW2	L1	L2	Material
0419-2003-0806	WE08 LL M6x1	8	LL	M6x1 con	12	14	21	25	Stainless steel 316TI
0419-2003-0808	WE08 LL M8x1	8	LL	M8x1 con	12	14	21	25	Stainless steel 316TI
0419-2003-0810	WE08 LL M10x1	8	LL	M10x1 con	12	14	17	25	Stainless steel 316TI
0419-2103-0802	WE08 LL R1/8	8	LL	R1/8 BSP con	12	14	21	25	Stainless steel 316TI

For the perpendicular connection of lubrication lines and hoses to your central lubrication system. This coupling, which is fully compliant with DIN 2353, is available in various sizes and designs, including BEKA, LINCOLN and SKF variants. The different sizes and variants can be found in the table below.

Material: Zinc-Nickel, stainless steel 316TI