



Screw sleeves / Hose studs



Screw sleeves / Hose studs

SCREW SLEEVE (HAF)

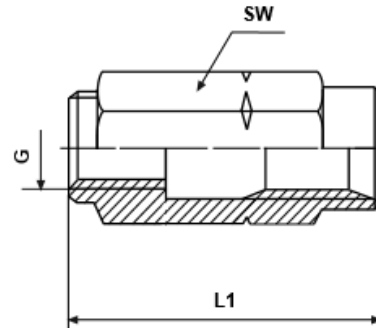

| Partnr | G | SW1 | Assembly hose | Material |
|----------------|---------|-----|---------------|-----------------------|
| 2875-0000-0400 | M7X0,75 | 12 | 4,0x8,6 | Zinc-nickel |
| 2875-0000-0401 | M7X0,75 | 12 | 4,0x8,6 | Zinc-iron |
| 2875-0000-0600 | M9X1 | 17 | 6,3x11,3 | Zinc-nickel |
| 2875-2000-0400 | M7X0,75 | 12 | 4,0x8,6 | Stainless steel 316TI |
| 2875-2000-0600 | M9X1 | 17 | 6,3x11,3 | Stainless steel 316TI |

Suitable for applications on high pressure central lubrication pipes. This coupling is available in various versions including BEKA, LINCOLN and SKF versions, all variants in original quality.

Haf 4 for mounting high-pressure hose 4.0 x 8.6
Haf 6.3 for mounting high pressure hose 6.3 x 11.3

Screw sleeves / Hose studs

HOSESTUD WITH LINCOLN GROOVE

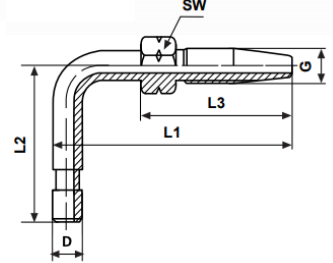
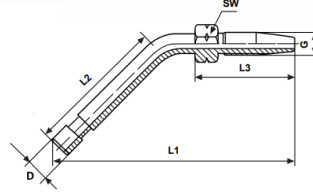
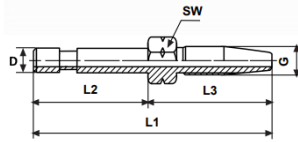

| Partnr | Description | D | G | L1 | L2 | L3 | Assembly hose | SW | Material |
|----------------|-------------------|---|---------|----|------|----|---------------|----|-----------------------|
| 2804-0007-0604 | Schroefpilaar | 6 | M7X0,75 | 54 | 21,5 | 31 | 4,0x8,6 | 10 | Zinc-iron |
| 2804-0009-0604 | Schroefpilaar | 6 | M7X0,75 | 61 | 30 | 31 | 4,0x8,6 | 10 | Zinc-iron |
| 2804-0402-0604 | Schroefpilaar 45° | 6 | M7X0,75 | 64 | 19,5 | 31 | 4,0x8,6 | 10 | Zinc-iron |
| 2804-0906-0604 | Schroefpilaar 90° | 6 | M7X0,75 | 60 | 36 | 31 | 4,0x8,6 | 10 | Zinc-iron |
| 2804-0907-0604 | Schroefpilaar 90° | 6 | M7X0,75 | 60 | 46 | 31 | 4,0x8,6 | 10 | Zinc-iron |
| 2804-2002-0604 | Schroefpilaar | 6 | M7X0,75 | 54 | 21,5 | 31 | 4,0x8,6 | 10 | Stainless steel 316TI |
| 2804-2902-0604 | Schroefpilaar 90° | 6 | M7X0,75 | 60 | 36 | 31 | 4,0x8,6 | 10 | Stainless steel 316TI |

Screw sleeves / Hose studs

HOSESTUD WITH SKF/BEKA GROOVE

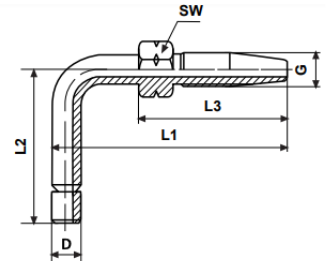
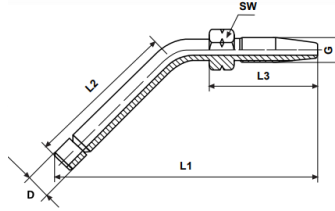
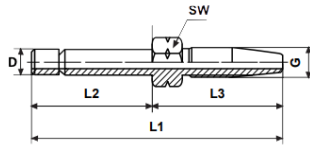

| Partnr | Description | D | G | L1 | L2 | L3 | Assembly hose | SW | Material |
|----------------|-------------------|---|---------|----|------|----|---------------|----|-----------------------|
| 2804-0005-0604 | Schroefpilaar | 6 | M7X0,75 | 64 | 32,7 | 31 | 4,0x8,6 | 10 | Zinc-nickel |
| 2804-0006-0604 | Schroefpilaar | 6 | M7X0,75 | 57 | 26 | 31 | 4,0x8,6 | 10 | Zinc-nickel |
| 2804-0401-0604 | Schroefpilaar 45° | 6 | M7X0,75 | 64 | 26 | 31 | 4,0x8,6 | 10 | Zinc-nickel |
| 2804-0908-0604 | Schroefpilaar 90° | 6 | M7X0,75 | 47 | 36 | 31 | 4,0x8,6 | 10 | Zinc-nickel |
| 2804-2001-0604 | Schroefpilaar | 6 | M7X0,75 | 64 | 32,7 | 31 | 4,0x8,6 | 10 | Stainless steel 316TI |

Screw sleeves / Hose studs

HOSESTUDS WITHOUT GROOVE

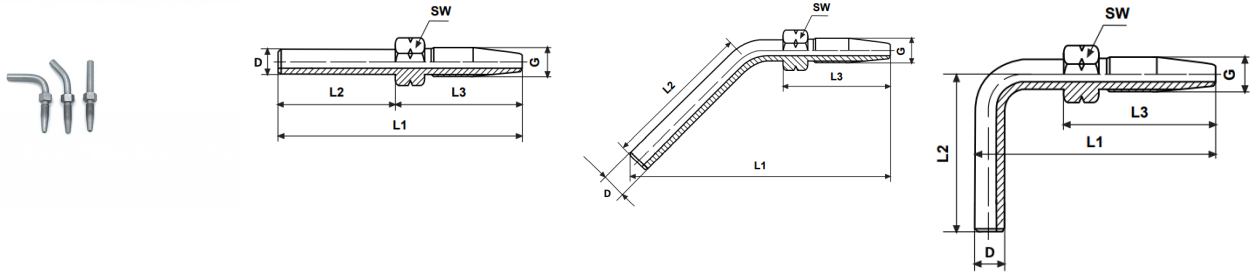

| Partnr | Description | D | G | L1 | L2 | L3 | SW1 | Assembly hose | Material |
|----------------|--------------|----|---------|------|------|------|-----|---------------|-------------|
| 2804-0000-0404 | Hosestud | 4 | M7X0,75 | 61 | 30 | 31 | 10 | 4,0x8,6 | Zinc-nickel |
| 2804-7001-0604 | Hosestud | 6 | M7X0,75 | 49,1 | 18 | 31 | 10 | 4,0x8,6 | Zinc-nickel |
| 2804-0001-0604 | Hosestud | 6 | M7X0,75 | 51,1 | 20 | 31 | 10 | 4,0x8,6 | Zinc-nickel |
| 2804-0002-0604 | Hosestud | 6 | M7X0,75 | 55,1 | 24 | 31 | 10 | 4,0x8,6 | Zinc-nickel |
| 2804-0000-0604 | Hosestud | 6 | M7X0,75 | 61,1 | 30 | 31 | 10 | 4,0x8,6 | Zinc-nickel |
| 2804-0000-0804 | Hosestud | 8 | M7X0,75 | 61,1 | 30 | 31 | 10 | 4,0x8,6 | Zinc-nickel |
| 2804-0000-0606 | Hosestud | 6 | M9X1 | 67 | 22 | 45,5 | 12 | 6,3x11,3 | Zinc-nickel |
| 2804-0000-0806 | Hosestud | 8 | M9X1 | 67,3 | 22 | 45,5 | 12 | 6,3x11,3 | Zinc-nickel |
| 2804-0000-1006 | Hosestud | 10 | M9X1 | 67,3 | 22 | 45,5 | 12 | 6,3x11,3 | Galvanised |
| 2804-0400-0604 | Hosestud 45° | 6 | M7X0,75 | 55,1 | 22 | 31 | 10 | 4,0x8,6 | Zinc-nickel |
| 2804-0403-0604 | Hosestud 45° | 6 | M7X0,75 | 68,3 | 25 | 31 | 10 | 4,0x8,6 | Zinc-nickel |
| 2804-0404-0604 | Hosestud 45° | 6 | M7X0,75 | 63,3 | 20 | 31 | 10 | 4,0x8,6 | Zinc-nickel |
| 2804-0405-0604 | Hosestud 45° | 6 | M7X0,75 | 79,1 | 38 | 31 | 10 | 4,0x8,6 | Zinc-nickel |
| 2804-0400-0806 | Hosestud 45° | 8 | M9X1 | 104 | 30 | 45,5 | 12 | 6,3x11,3 | Zinc-nickel |
| 2804-0900-0604 | Hosestud 90° | 6 | M7X0,75 | 48 | 30 | 31 | 10 | 4,0x8,6 | Zinc-nickel |
| 2804-0901-0604 | Hosestud 90° | 6 | M7X0,75 | 48 | 20,7 | 31 | 10 | 4,0x8,6 | Zinc-nickel |
| 2804-0902-0604 | Hosestud 90° | 6 | M7X0,75 | 55,1 | 52 | 31 | 10 | 4,0x8,6 | Zinc-nickel |
| 2804-0903-0604 | Hosestud 90° | 6 | M7X0,75 | 62 | 38 | 31 | 10 | 4,0x8,6 | Zinc-nickel |
| 2804-0904-0604 | Hosestud 90° | 6 | M7X0,75 | 48 | 32,7 | 31 | 10 | 4,0x8,6 | Zinc-nickel |
| 2804-0909-0604 | Hosestud 90° | 6 | M7X0,75 | 62 | 50 | 31 | 10 | 4,0x8,6 | Zinc-nickel |
| 2804-0900-0606 | Hosestud 90° | 6 | M9X1 | 70 | 53 | 45,5 | 12 | 6,3x11,3 | Zinc-nickel |
| 2804-0900-0806 | Hosestud 90° | 8 | M9X1 | 70 | 55 | 45,5 | 12 | 6,3x11,3 | Zinc-nickel |
| 2804-0901-0806 | Hosestud 90° | 8 | M9X1 | 70 | 35 | 45,5 | 12 | 6,3x11,3 | Zinc-nickel |

| Partnr | Description | D | G | L1 | L2 | L3 | SW1 | Assembly hose | Material |
|----------------|--------------------|----------|----------|-----------|-----------|-----------|------------|----------------------|-----------------------|
| 2804-2000-0404 | Hosestud | 4 | M7X0,75 | 61 | 30 | 31 | 10 | 4,0x8,6 | Stainless steel 316TI |
| 2804-2000-0604 | Hosestud | 6 | M7X0,75 | 61,1 | 30 | 31 | 10 | 4,0x8,6 | Stainless steel 316TI |
| 2804-2000-0606 | Hosestud | 6 | M9X1 | 67,3 | 22 | 45,5 | 12 | 6,3x11,3 | Stainless steel 316TI |
| 2804-2000-0806 | Hosestud | 8 | M9X1 | 67,3 | 22 | 45,5 | 12 | 6,3x11,3 | Stainless steel 316TI |
| 2804-2000-1006 | Hosestud | 8 | M9X1 | 67,3 | 22 | 45,5 | 12 | 6,3x11,3 | Stainless steel 316TI |
| 2804-2400-0604 | Hosestud 45° | 6 | M7X0,75 | 55,1 | 22 | 31 | 10 | 4,0x8,6 | Stainless steel 316TI |
| 2804-2900-0604 | Hosestud 90° | 6 | M7X0,75 | 48 | 30 | 31 | 10 | 4,0x8,6 | Stainless steel 316TI |
| 2804-2901-0604 | Hosestud 90° | 6 | M7X0,75 | 48 | 20,7 | 31 | 10 | 4,0x8,6 | Stainless steel 316TI |

